

NWCA -1 2-1 WR-12 to 1.0mm

Waveguide to Coax Adapters

Features:
* Low VSWR

Applications:
* Wireless
* Transmitter
* Laboratory Test
* Radar

Electrical

Frequency: 60~90GHz
VSWR: 1.35 max.
Insertion Loss: 1.1dB max.
Impedance: 50Ω

Mechanical

RF Connectors: 1.0mm
Interface: WR-12
Flange: UG-387/U
Material: Gold plated brass
Outer Conductor: Passivated stainless steel
Dielectric: PE
Inner Conductor: Gold plated beryllium copper

Environmental

Temperature: -55~+60°C

How To Order

NWCA-12-X-Y

X: Connector type.

Y: End launch: E, Right angle: R.

Connector naming rules:

1F - 1.0mm Female (Outline A)

1 - 1.0mm Male (Outline B)

Examples:

To order a waveguide to coax adapter, WR-12 to 1.0mm female, end launch, specify NWCA-12-1F-E.

Customization is available upon request.

Outline Drawings

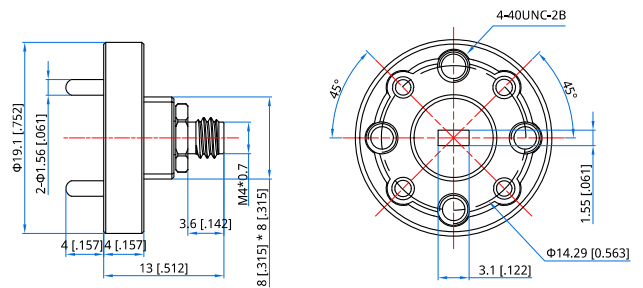

Outline A

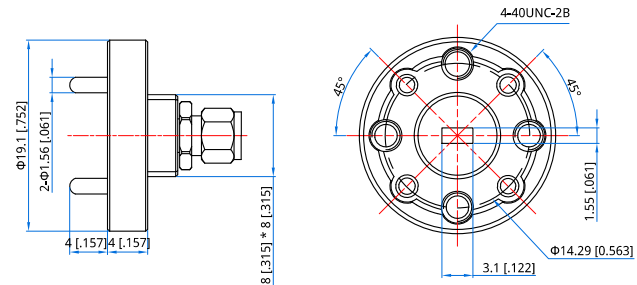

Outline B

Unit: mm [in]

Tolerance: ±0.2mm [±0.008in]