

NVLC-1F-1

1mm, DC~110GHz

Features:

- * Low VSWR
- * No welding
- * Reusable
- * Easy installation

Applications:

- * Laboratory Test

Electrical

Frequency:	DC~110GHz
VSWR:	1.5 max.
Impedance:	50Ω

Mechanical

RF Conductor:	1.0mm Female
Inner Conductor:	Gold plated beryllium copper
Outer Conductor:	SUS303 stainless steel

How To Order

NVLC-1F-1

Customization is available upon request.

Outline Drawings

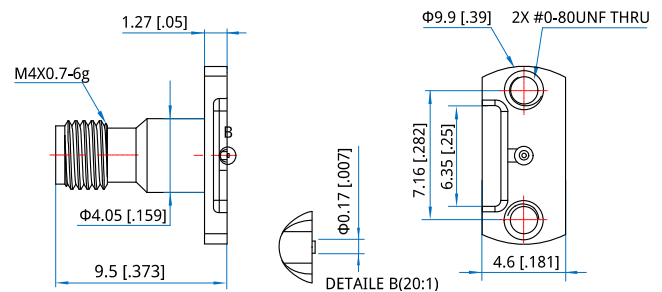

Unit: mm [in]

Tolerance: $\pm 0.2\text{mm}$ [$\pm 0.008\text{in}$]

NVLC-2F-1

DC~50GHz

Features:
* Low VSWR

Applications:
* Wireless
* Radar
* Instruments
* Electronics

Electrical

Frequency: DC~50GHz
VSWR: 1.2 max.
Impedance: 50Ω

Mechanical

RF Connector: 2.4mm female
Outer Conductor: Passivated SU303 stainless steel
Inner Conductor: Gold plated beryllium copper

Outline Drawings

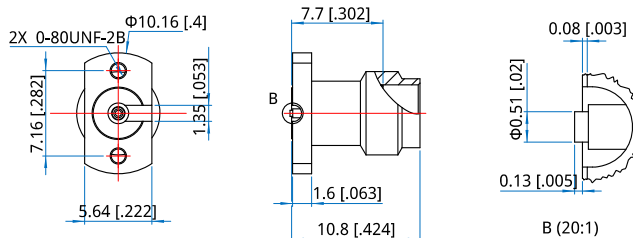

Unit: mm [in]

Tolerance: $\pm 0.2\text{mm}$ [$\pm 0.008\text{in}$]

How To Order

NVLC-2F-1

Customization is available upon request.

NVLC-K DC~40GHz

Features:
* Low VSWR

Applications:
* Wireless
* Radar
* Instruments
* Electronics

Electrical

Frequency: DC~40GHz
VSWR: 1.2 max.
Impedance: 50Ω

Mechanical

RF Connector: 2.92mm
Outer Conductor: Passivated SU303 Stainless Steel
Inner Conductor: Gold Plated Beryllium Copper

Environmental

Temperature: -55~+165°C

How To Order

NVLC-KF-1 - Outline A

NVLC-KF-2 - Outline B

Customization is available upon request.

Outline Drawings

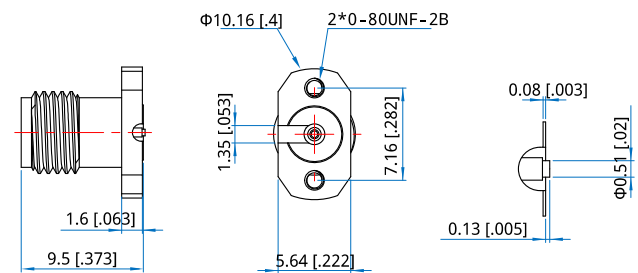

Outline A

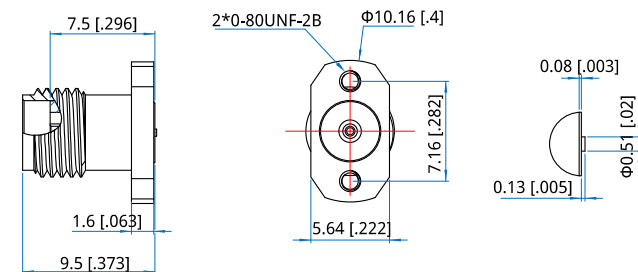

Outline B

Unit: mm [in]

Tolerance: ±0.2mm [±0.008in]

NVLC-SF-1

SMA, DC~18GHz

Features:

- * Low VSWR
- * No welding
- * Reusable
- * Easy installation

Applications:

- * Laboratory Test

Electrical

Frequency:	DC~18GHz
VSWR:	1.3 max.
Impedance:	50Ω

Mechanical

RF Conductor:	SMA Female
Inner Conductor:	Gold plated beryllium copper
Dielectric:	PTFE
Outer Conductor:	Nickel Plated Brass

Environmental

Temperature:	-55~+165°C
--------------	------------

Outline Drawings

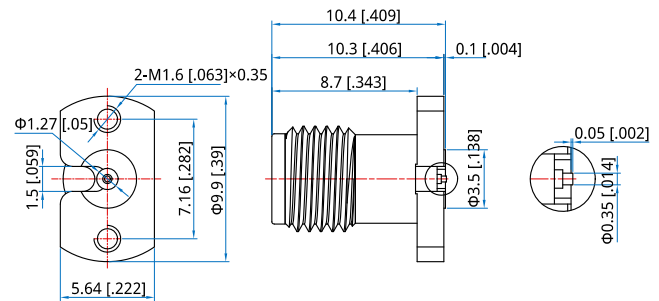

Unit: mm [in]

Tolerance: ±0.2mm [±0.008in]

How To Order

NVLC-SF-1

Customization is available upon request.

NVLC-VF-1

1.85mm, DC~65GHz

Features:

- * Low VSWR
- * No welding
- * Reusable
- * Easy installation

Applications:

- * Laboratory Test

Electrical

Frequency:	DC~65GHz
VSWR:	1.4 max.
Impedance:	50Ω

Mechanical

RF Conductor:	1.85mm Female
Inner Conductor:	Gold plated beryllium copper
Outer Conductor:	SUS303 stainless steel

Environmental

Temperature:	-55~+165°C
--------------	------------

How To Order

NVLC-VF-1

Customization is available upon request.

Outline Drawings

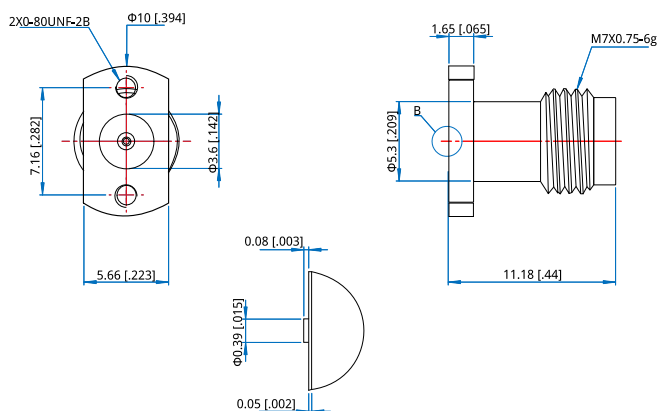

Unit: mm [in]

Tolerance: $\pm 0.2\text{mm}$ [$\pm 0.008\text{in}$]