

KD 201

10 MHz to 18 GHz

Noise Diodes

KTB'S noise diodes are the fundamental building blocks of all noise systems. They are hand-picked for performance characteristics that make them ideally suited to broadband noise generation with flat response.



All KTB noise diodes deliver symmetrical white Gaussian noise and flat output power versus frequency. The diodes are hermetically sealed and available in a wide variety of package styles. Special package configurations or screening processes are available upon request.

Model	Frequency Range	Operating Voltage (v)	ENR (dB)	Impedance (ohm)	Bias (mA)
KD201	10MHz to 18GHz	6-12V	30	50	10mA (typical)

*Note: Assembly wirebondable for KD201

KD201

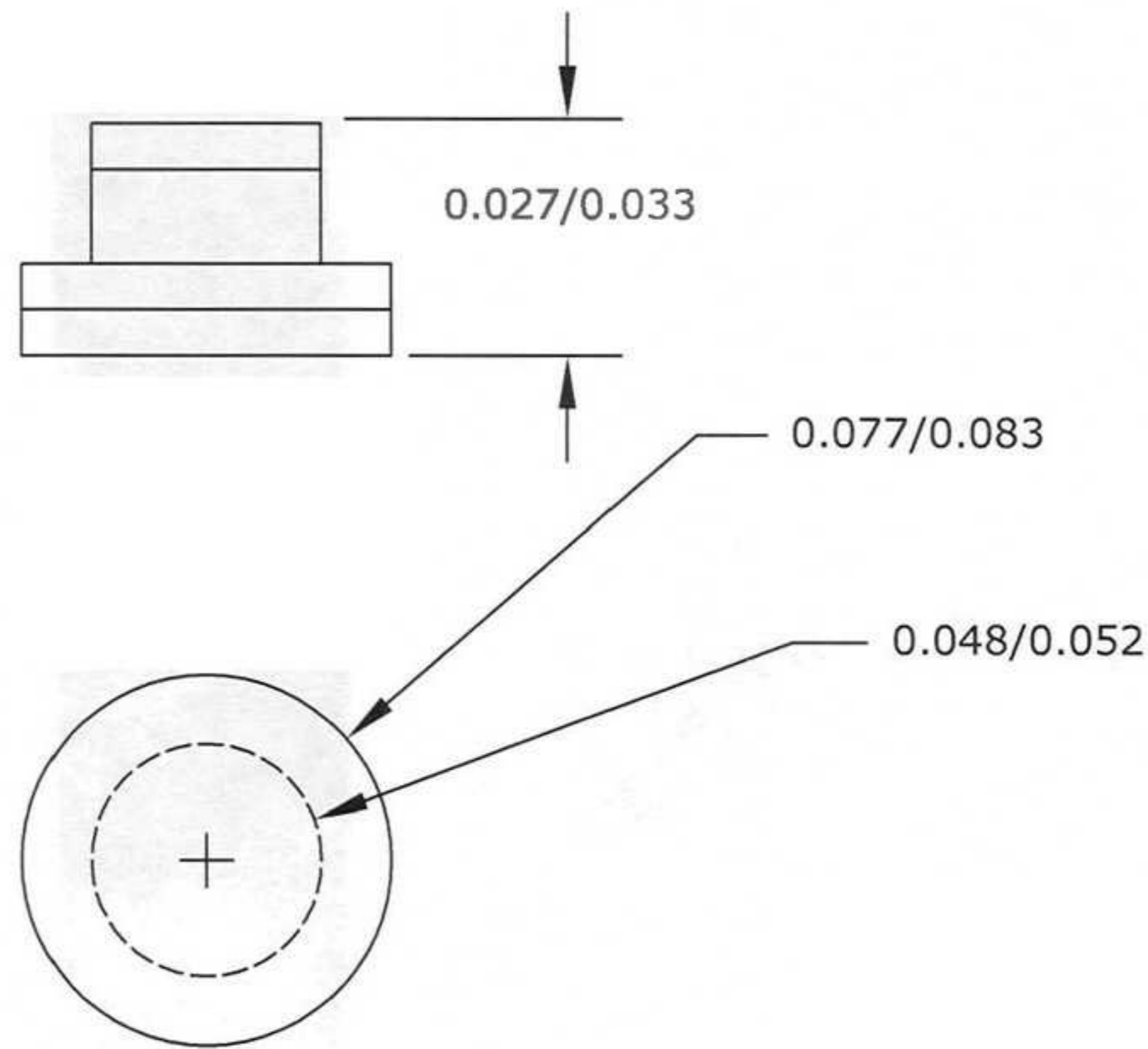

Features

- Custom electrical testing available upon request.
- Wide package variety with custom configurations.
- Can deliver symmetrical white Gaussian noise and flat output power versus frequency.
- Be used for RF and Microwave applications.
- Classified based on performance traits that improve their broadband noise output and produce a flat spectral response.



KTBSOLUTIONS INC.

1754 Technology DR STE 122
 San Jose, CA, 95110, USA
 Tel: +1 650 686 1019
 E-mail: sales@ktbsolutions.com
 Web: www.ktbsolutions.com