

NFM2-50000-75000

X2, 50~75GHz

Features:

- * Broadband
- * Low Power Consumption

Applications:

- * Wireless
- * Transmitter
- * Laboratory Test

Electrical

Output Frequency:	50~75GHz
Input Frequency:	25~37.5GHz
Multiplication Factor:	2
Output Power:	6dBm min.
Input Power:	22dBm min.

Mechanical

Size: 32.7*19.1*21.1mm
1.287*0.752*0.831in

RF Input Interface: WR-28

RF Output Interface: WR-15

[1] Exclude connectors.

Environmental

Operating Temperature:	0~+40°C
Non-operating Temperature:	-40~+85°C

Outline Drawings

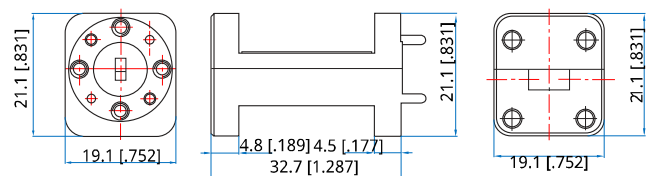

Unit: mm [in]

Tolerance: ±0.2mm [±0.008in]

How To Order

NFM2-50000-75000

Customization is available upon request.