

NELC-K-3

2.92mm, DC~40GHz

Features:

- * Low VSWR
- * No welding
- * Reusable
- * Easy installation

Applications:

- * Laboratory Test

Electrical

Frequency:	DC~40GHz
VSWR:	1.25 max.
Impedance:	50Ω

Mechanical

RF Connector:	2.92mm
Outer Conductor:	Passivated stainless steel
Dielectric:	PEI & PTFE
Inner Conductor:	Gold plated beryllium copper

Environmental

Temperature:	-55~+165°C
--------------	------------

How To Order

NELC-K-3 - Outline A

NELC-KF-3 - Outline B

Customization is available upon request.

Outline Drawings

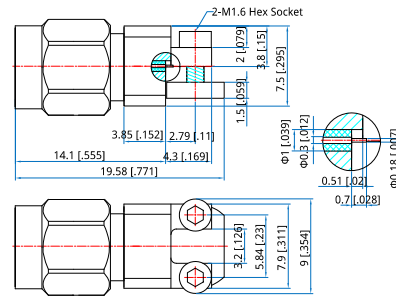

Outline A

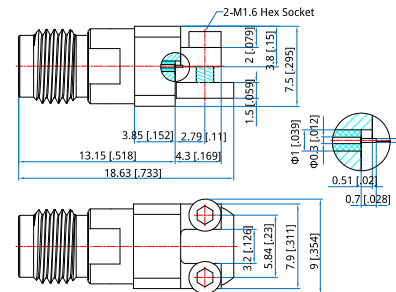

Outline B

Unit: mm [in]
Tolerance: ±0.2mm [±0.008in]

