

## NELC-2-3

### 2.4mm, DC~50GHz

#### Features:

- \* Low VSWR
- \* No welding
- \* Reusable
- \* Easy installation

#### Applications:

- \* Laboratory Test

#### Electrical

Frequency:	DC~50GHz
VSWR:	1.3 max.
Impedance:	50Ω

#### Mechanical

RF Connector:	2.4mm
Outer Conductor:	Passivated stainless steel
Dielectric:	PEI & PTFE
Inner Conductor:	Gold plated beryllium copper

#### Environmental

Temperature:	-55~+165°C
--------------	------------

#### How To Order

[NELC-2-3](#) - Outline A

[NELC-2F-3](#) - Outline B

Customization is available upon request.

#### Outline Drawings

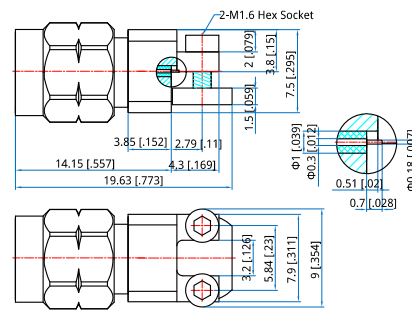

Outline A

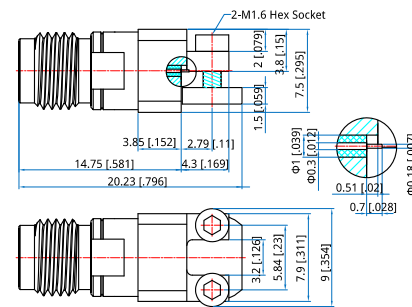

Outline B

Unit: mm [in]  
Tolerance: ±0.2mm [±0.008in]