



Table of Contents

ND-10-8000.....	1
ND-10-18000.....	2
ND-10-26500.....	3
ND-10-40000.....	4
NWD-28.....	5
NWD-22.....	6
NWD-19.....	7
NWD-15.....	8
NWD-10.....	9



ND-10-8000

Broadband & High Sensitivity

Features:

- * Broadband
- * High Sensitivity

Applications:

- * Telecom
- * Instrumentation
- * Laboratory Test
- * Radar

Electrical

Frequency Range:	0.01~8GHz
Sensitivity:	400mV/mW
Flatness:	±0.8dB max.
VSWR:	1.5 max.
Polarity:	Negative
Input Power Without Damage:	20dBm

Mechanical

Size*1:	Φ9.5*35.8mm Φ0.374*1.409in
Weight:	100g max.
Input Connector:	SMA Male
Output Connector:	SMA Female

Environmental

Operating Temperature:	0~+50°C
Non-operating Temperature:	-20~+70°C

Outline Drawings

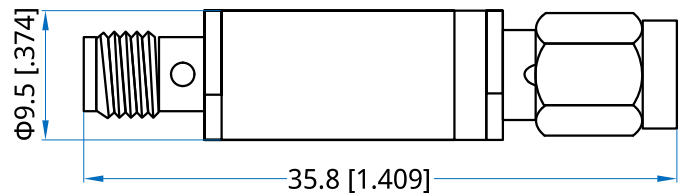

Unit: mm [in]

Tolerance: ±0.2mm [±0.008in]

How To Order

ND-10-8000

Customization is available upon request.

ND-10-18000

Broadband & High Sensitivity

Features:

- * Broadband
- * High Sensitivity

Applications:

- * Telecom
- * Instrumentation
- * Laboratory Test
- * Radar

Electrical

Frequency Range:	0.01~18GHz
Sensitivity:	400mV/mW
Flatness:	±1dB max.
VSWR:	2 max.
Polarity:	Negative
Input Power Without Damage:	20dBm

Mechanical

Size*1:	Φ9.5*35.8mm Φ0.374*1.409in
Weight:	100g max.
Input Connector:	SMA Male
Output Connector:	SMA Female

Environmental

Operating Temperature:	0~+50°C
Non-operating Temperature:	-20~+70°C

Outline Drawings

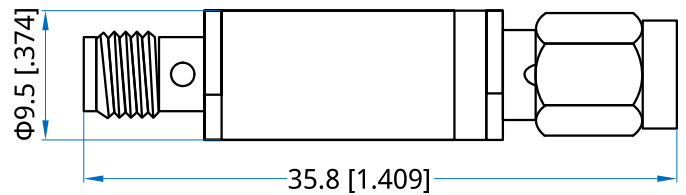

Unit: mm [in]

Tolerance: ±0.2mm [±0.008in]

How To Order

ND-10-18000

Customization is available upon request.

ND-10-26500

Broadband & High Sensitivity

Features:

- * Broadband
- * High Sensitivity

Applications:

- * Telecom
- * Instrumentation
- * Laboratory Test
- * Radar

Electrical

Frequency Range:	0.01~26.5GHz
Sensitivity:	400mV/mW
Flatness:	±1.5dB max.
VSWR:	2 max.
Polarity:	Negative
Input Power Without Damage:	20dBm

Mechanical

Size*1:	Φ9.5*41.6mm Φ0.374*1.638in
Weight:	100g max.
Input Connector:	3.5mm Male
Output Connector:	SMA Female

Environmental

Operating Temperature:	0~+50°C
Non-operating Temperature:	-20~+70°C

Outline Drawings

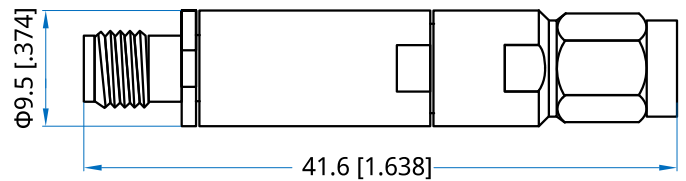

Unit: mm [in]

Tolerance: ±0.2mm [±0.008in]

How To Order

ND-10-26500

Customization is available upon request.

ND-10-40000

Broadband & High Sensitivity

Features:

- * Broadband
- * High Sensitivity

Applications:

- * Telecom
- * Instrumentation
- * Laboratory Test
- * Radar

Electrical

Frequency Range:	0.01~40GHz
Sensitivity:	350mV/mW
Flatness:	±1.75dB max.
VSWR:	2 max.
Polarity:	Negative
Input Power Without Damage:	20dBm

Mechanical

Size*1:	Φ9.5*34.8mm
	Φ0.374*1.370in
Weight:	100g max.
Input Connector:	2.4mm Male
Output Connector:	SMA Female

Environmental

Operating Temperature:	0~+50°C
Non-operating Temperature:	-20~+70°C

Outline Drawings

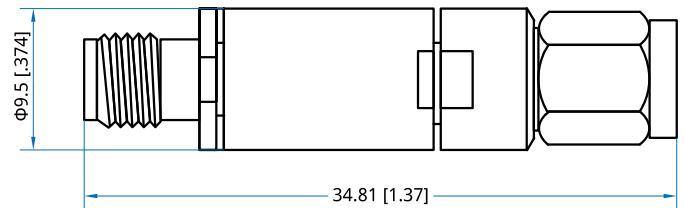

Unit: mm [in]

Tolerance: ±0.2mm [±0.008in]

How To Order

ND-10-40000

Customization is available upon request.

NWD-28

Broadband & High Sensitivity

Features:

- * Broadband
- * High Sensitivity

Applications:

- * Telecom
- * Instrumentation
- * Laboratory Test
- * Radar

Electrical

Frequency Range:	26.5~40GHz
Sensitivity:	300mV/mW
Flatness:	±1.5dB max.
Polarity:	Negative
Input Power Without Damage:	20dBm

Mechanical

Size:	34.5*33.7*19mm 1.358*1.327*0.748in
Weight:	150g max.
Input Connector:	WR-28
Output Connector:	SMA Female

Environmental

Operating Temperature:	0~+50°C
Non-operating Temperature:	-20~+70°C

Outline Drawings

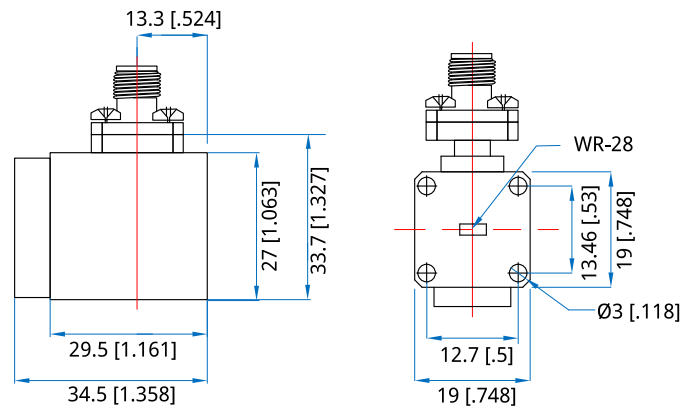

Unit: mm [in]

Tolerance: ±0.2mm [±0.008in]

How To Order

NWD-28

Customization is available upon request.

NWD-22

Broadband & High Sensitivity

Features:

- * Broadband
- * High Sensitivity

Applications:

- * Telecom
- * Instrumentation
- * Laboratory Test
- * Radar

Electrical

Frequency Range:	33~50GHz
Sensitivity:	300mV/mW
Flatness:	±1.8dB max.
Polarity:	Negative
Input Power Without Damage:	20dBm

Mechanical

Size:	30*42.5*17mm 1.181*1.673*0.669in
Weight:	150g max.
Input Connector:	WR-22
Output Connector:	SMA Female

Environmental

Operating Temperature:	0~+50°C
Non-operating Temperature:	-20~+70°C

Outline Drawings

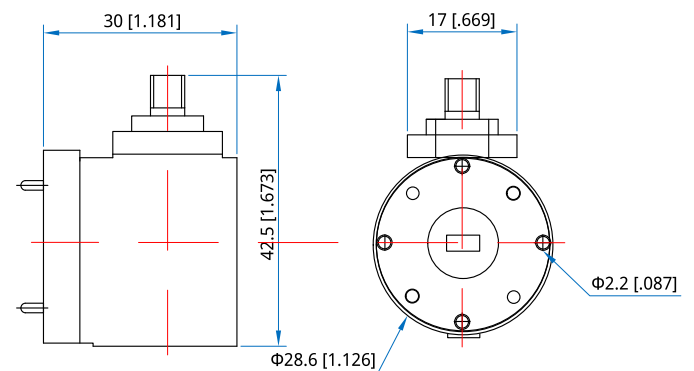

Unit: mm [in]

Tolerance: ±0.2mm [±0.008in]

How To Order

NWD-22

Customization is available upon request.

NWD-19

Broadband & High Sensitivity

Features:

- * Broadband
- * High Sensitivity

Applications:

- * Telecom
- * Instrumentation
- * Laboratory Test
- * Radar

Electrical

Frequency Range:	40~60GHz
Sensitivity:	300mV/mW
Flatness:	±1.8dB max.
Polarity:	Negative
Input Power Without Damage:	20dBm

Mechanical

Length:	24.5mm 0.965in
Weight:	150g max.
Input Connector:	WR-19
Output Connector:	SMA Female

Environmental

Operating Temperature:	0~+50°C
Non-operating Temperature:	-20~+70°C

Outline Drawings

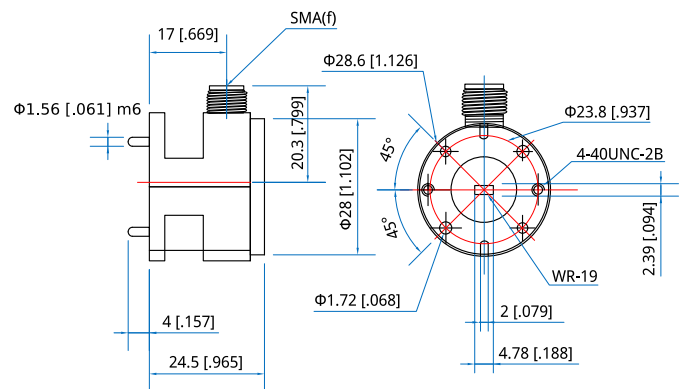

Unit: mm [in]

Tolerance: $\pm 0.2\text{mm}$ [$\pm 0.008\text{in}$]

How To Order

NWD-19

Customization is available upon request.

NWD-15

Broadband & High Sensitivity

Features:

- * Broadband
- * High Sensitivity

Applications:

- * Telecom
- * Instrumentation
- * Laboratory Test
- * Radar

Electrical

Frequency Range:	50~75GHz
Sensitivity:	200mV/mW
Flatness:	±2dB max.
Polarity:	Negative
Input Power Without Damage:	20dBm

Mechanical

Size:	30*17.6*38.6mm 1.181*0.693*1.52in
Weight:	150g max.
Input Connector:	WR-15
Output Connector:	SMA Female

Environmental

Operating Temperature:	0~+50°C
Non-operating Temperature:	-20~+70°C

Outline Drawings

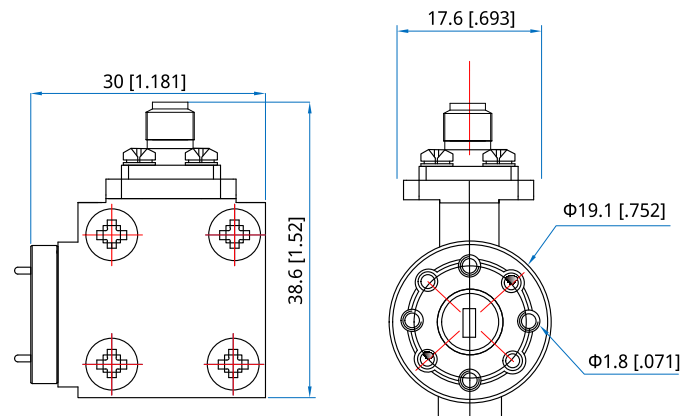

Unit: mm [in]

Tolerance: ±0.2mm [±0.008in]

How To Order

NWD-15

Customization is available upon request.

NWD-10

Broadband & High Sensitivity

Features:

- * Broadband
- * High Sensitivity

Applications:

- * Telecom
- * Instrumentation
- * Laboratory Test
- * Radar

Electrical

Frequency Range:	75~110GHz
Sensitivity:	100mV/mW
Flatness:	±2.2dB max.
Polarity:	Negative
Input Power Without Damage:	20dBm

Mechanical

Length:	26.5mm 1.043in
Weight:	150g max.
Input Connector:	WR-10
Output Connector:	SMA Female

Environmental

Operating Temperature:	0~+50°C
Non-operating Temperature:	-20~+70°C

Outline Drawings

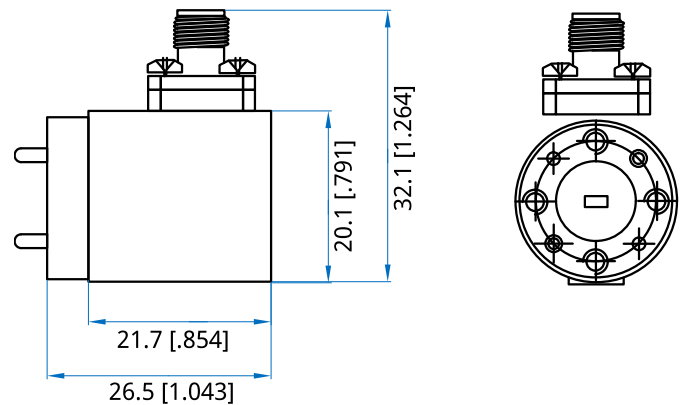

Unit: mm [in]

Tolerance: ±0.2mm [±0.008in]

How To Order

NWD-10

Customization is available upon request.