

NCT1802

DC~18GHz, 2W

Features:
 * Low VSWR
 * Broadband

Applications:
 * Transmitters
 * Antennas
 * Laboratory Test
 * Impedance Matching



Electrical

Frequency Range: DC~18GHz
 Average Power¹: 2W@25°C max.
 Impedance: 50Ω

[1] Derated linearly to 0.1W@120°C.

VSWR

Frequency (GHz)	VSWR ² (max.)	VSWR ³ (max.)
DC~4	1.20	1.15
DC~8	1.25	1.20
DC~12.4	1.30	1.25
DC~18	1.40	1.30

[2] N connector

[3] SMA connector

Mechanical

Connectors: N, SMA

Environmental

Temperature: -55~+125°C

Outline Drawings

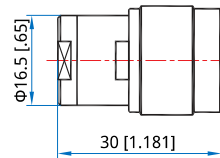

Outline A

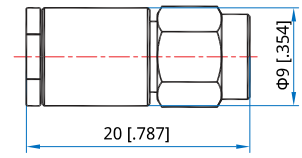

Outline B

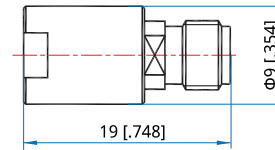

Outline C

Unit: mm [in]

Tolerance: ±1mm [±0.04in]

How To Order

NCT1802-X-Y

X: Frequency in GHz

Y: Connector type

Connector naming rules:

N - N male (Outline A)

NF - N female

S - SMA male (Outline B)

SF - SMA female (Outline C)

Examples:

To order a termination, DC-12.4GHz, SMA male, specify NCT1802-12.4-S.

Customization is available upon request.