

NCI-4000-8000-K2-K2-N-1

4~8GHz, 200W, 200W, N Female, Clockwise

Features:

- * Broadband
- * High Power
- * Low Insertion Loss

Applications:

- * Wireless
- * Radar
- * Laboratory Test

Electrical

Frequency:	4~8GHz
VSWR:	1.5 max.
Insertion Loss:	0.6dB max.
Isolation:	15dB min.
Forward Power:	200W
Reverse Power:	200W

Mechanical

Size ^{*1} :	29.7*100*30mm 1.169*3.937*1.181in
RF Connectors:	N Female
Direction:	Clockwise

[1] Exclude connectors and terminations.

Environmental

Operating Temperature:	-20~+60°C
Non-operating Temperature:	-55~+85°C

Outline Drawings

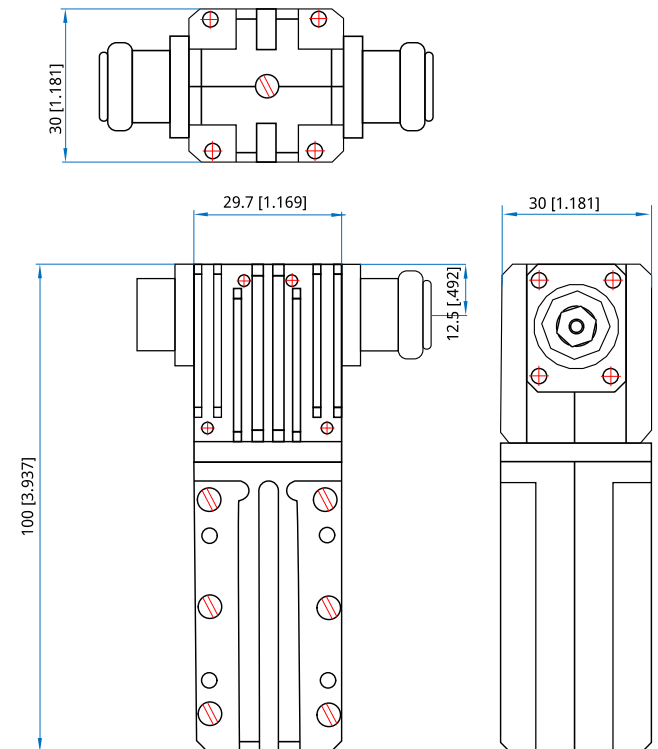

Unit: mm [in]

Tolerance: $\pm 0.2\text{mm}$ [$\pm 0.008\text{in}$]

How To Order

NCI-4000-8000-K2-K2-N-1

Customization is available upon request.