

NCC1220C

High Power, High Isolation

Features:

- * High Power
- * High Isolation
- * Low Insertion Loss
- * Low VSWR

Applications:

- * Wireless
- * Radar
- * Laboratory Test

Description

NCC1220C series Coaxial Circulators cover frequency range 9~16.5GHz. High power, high isolation and low insertion loss make it ideal for a lot of applications like amplifiers, transceivers, etc.

Specifications

Frequency (MHz)	Bandwidth (MHz)	IL (dB Max.)	Isolation (dB Min.)	VSWR (Max.)	Average Power (W)	Connector	Temperature (°C)
9300~9500	200	0.30	23.0	1.25	30	SMA	-10~+60
10500~12500	2000	0.40	20.0	1.25	30	SMA	-10~+60
10700~12800	2100	0.40	20.0	1.25	30	SMA	-10~+60
12700~14900	2200	0.50	19.0	1.30	30	SMA	-10~+60
14500~16500	2000	0.40	20.0	1.25	30	SMA	-10~+60

Outline Drawings

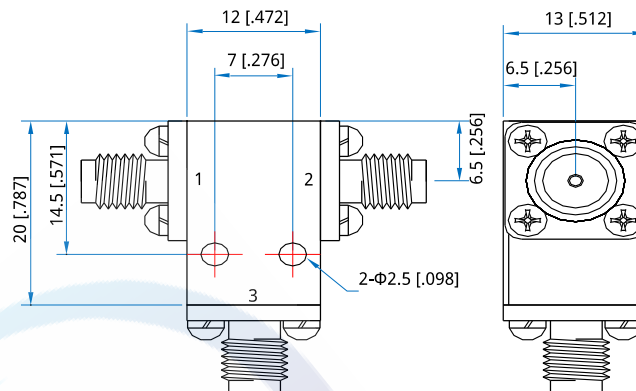

Unit: mm [inch]

Tolerance: ±0.2mm [±0.008in]

Mechanical

Size*1: 12*20*13mm
0.472*0.787*0.512in

Mounting: 2-Φ2.5mm through-hole

[1] Exclude connectors

Connector Naming Rules:

S - SMA Female

How To Order

NCC1220C-W-X-Y-Z

W: Start frequency in MHz

X: Stop frequency in MHz

Y: Average power in W

Z: Connector type

Examples:

To order a NCC1220C series Circulator, 9.3~9.5GHz, 30W, SMA female, specify NCC1220C-9300-9500-30-S.

Customization is available upon request.