

NCM-MCB-R280-1

MCX Male

Features:
* Low VSWR

Applications:
* Wireless
* Radar
* Instruments
* Electronics

Electrical

| | |
|--------------------------|-------------|
| Frequency: | DC~6GHz |
| Impedance of Dielectric: | 5000MΩ min. |
| Voltage Withstand: | 500V |
| VSWR: | 1.3 max. |
| Impedance: | 50Ω |

Mechanical

| | |
|------------------|-------------------|
| RF Connector: | MCX male |
| Mating Cable: | NR280 |
| Outer Conductor: | Gold plated brass |
| Dielectric: | PTFE |
| Inner Conductor: | Gold plated brass |

Environmental

| | |
|--------------|------------|
| Temperature: | -55~+125°C |
|--------------|------------|

Outline Drawings

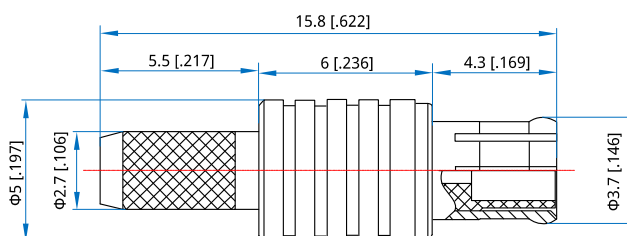

Unit: mm [in]

Tolerance: ± 0.2 mm [± 0.008 in]

How To Order

NCM-MCB-R280-1

Customization is available upon request.

NCM-MCB-R280-1

MCX Male

Features:
* Low VSWR

Applications:
* Wireless
* Radar
* Instruments
* Electronics

Electrical

| | |
|--------------------------|-------------|
| Frequency: | DC~6GHz |
| Impedance of Dielectric: | 5000MΩ min. |
| Voltage Withstand: | 500V |
| VSWR: | 1.3 max. |
| Impedance: | 50Ω |

Mechanical

| | |
|------------------|-------------------|
| RF Connector: | MCX male |
| Mating Cable: | NR280 |
| Outer Conductor: | Gold plated brass |
| Dielectric: | PTFE |
| Inner Conductor: | Gold plated brass |

Environmental

| | |
|--------------|------------|
| Temperature: | -55~+125°C |
|--------------|------------|

Outline Drawings

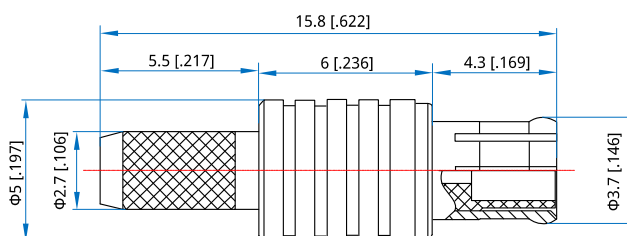

Unit: mm [in]

Tolerance: ± 0.2 mm [± 0.008 in]

How To Order

NCM-MCB-R280-1

Customization is available upon request.