

NPD4-2000-18000-20-S

4-Way, 2~18GHz

Features:

- * Small Size
- * Low Insertion Loss

Applications:

- * Amplifiers
- * Mixers
- * Antennas
- * Laboratory Test

Electrical

Frequency:	2~18GHz
Insertion Loss:	2.0dB max.
Input VSWR:	1.5 max.
Output VSWR:	1.4 max.
Isolation:	17dB min.
Amplitude Balance:	0.4dB max.
Phase Balance:	±6°
Impedance:	50Ω
Average Power:	20W max. 1W max. as combiner

Mechanical

Size ^{*1} :	60*69*10mm 2.362*2.717*0.394in
Weight:	108g
Connectors:	SMA Female
Mounting:	4-Φ2.3mm through-hole

[1] Exclude connectors.

Environmental

Operation Temperature: -45~+85°C

Outline Drawings

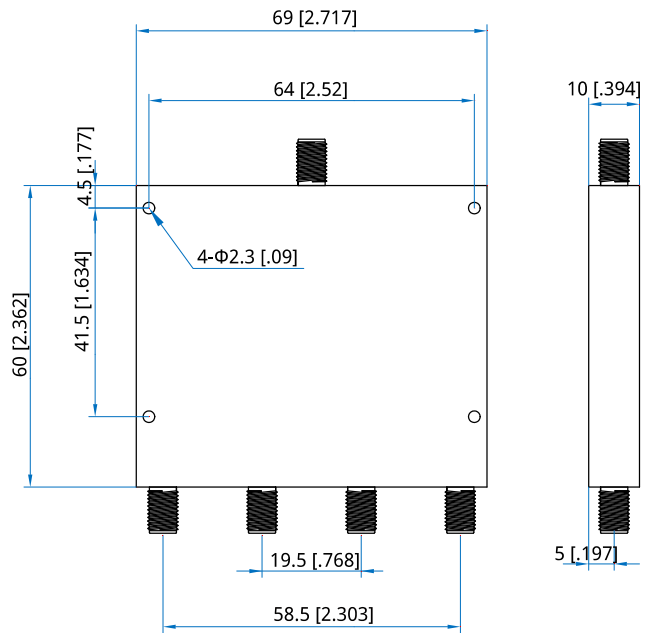

Unit: mm [in]
Tolerance: ±0.3mm [±0.012in]

How To Order

[NPD4-2000-18000-20-S](#)

Customization is available upon request.

