

**NPD4-200-4000**

4-Way, 0.2~4GHz

### Features:

- \* Small Size
- \* Low Insertion Loss

Applications:

- \* Amplifiers
- \* Mixers
- \* Antennas
- \* Laboratory Test

## Electrical

Frequency:	0.2~4GHz
Insertion Loss:	3.2dB max.
Input VSWR:	1.45 max.
Output VSWR:	1.25 max.
Isolation:	18dB min.
Amplitude Balance:	0.4dB max.
Phase Balance:	±4°
Impedance:	50Ω
Average Power:	30W max. 2W max. as combiner

## Mechanical

Size*1:	164*72*12mm 6.457*2.835*0.472in
Connectors:	SMA Female
Mounting:	4-Φ3.2mm through-hole

[1] Exclude connectors.

## Environmental

Operation Temperature: -35~+75°C

## Outline Drawings

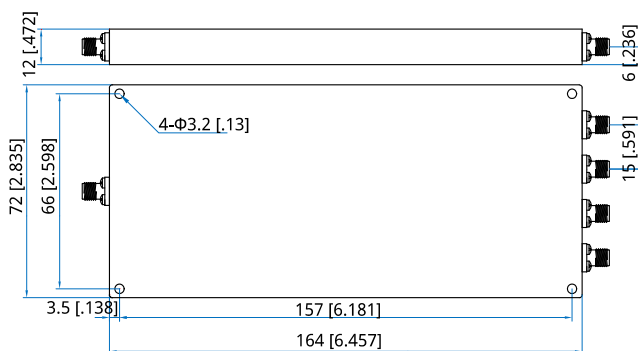

Unit: mm [in]

Tolerance:  $\pm 0.5\text{mm}$  [ $\pm 0.02\text{in}$ ]

## How To Order

NPD4-200-4000

Customization is available upon request.